

Agricultural Water Pump

FEATURES & BENEFITS



DC sprayer pump can handle chemical sprays as well as water.

Application:

- *Agriculture/Yacht/RV/Caravan Pressurized water system
- *Sprayer fixture (Vehicle-mounted sprayer,electric sprayer,battery sprayer, hand sprayer)
- *Food beverage filling & liquid transfer
- *Any other pressurization system.

Factory electric sprayer pumps Special Function:

- *Stable performance
- *Self priming, automatic switch
- *Low noise, corrosion resistant
- *Duty cycle:working intermittent

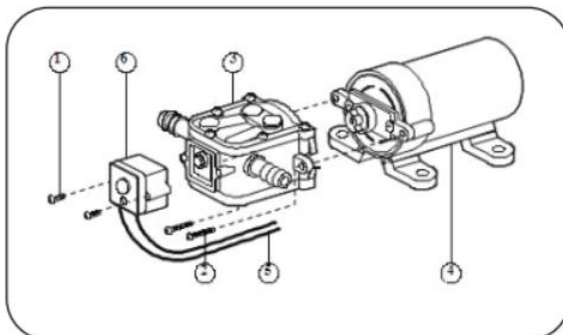

Key	DESCRIPTION	Key	DESCRIPTION
1	Switch cover screw	4	Motor
2	Pump head screws	5	Lead wire
3	Pump head	6	Pressure Switch

Technical Data

Model	Volt	Flow Rate (LPM/GPM)	Pressure (PSI/Bar)	Amps Draw (A)	BYPASS
FLO-2201	12V	2.0(0.52)	55(3.79)	1.8	YES
FLO-2202	12V	3.8(1.0)	35(2.41)	3	YES
FLO-2202-1	12V	4.3(1.13)	35(2.41)	3.5	YES
FLO-2203	12V	2.6(0.68)	70(4.83)	2.1	YES
FLO-2203-1	12	3.1(0.82)	70(4.83)	2.2	YES
FLO-2202A	12	4.0(1.05)	80(5.52)	2.6	YES
FLO-2401	24	2.0(0.52)	55(3.79)	0.9	YES
FLO-2402	24	3.8(1.0)	35(2.41)	1.5	YES
FLO-2403	24	2.6(0.68)	70(4.83)	1.0	YES
FLO-2402A	24	4.0(1.05)	80(5.52)	1.3	YES

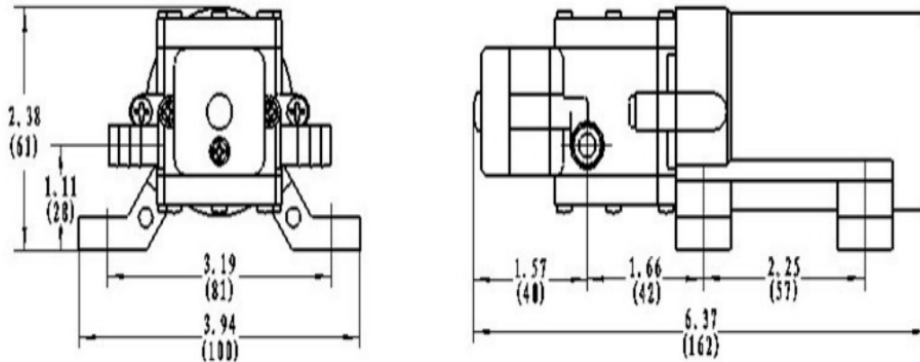

Image Gallery

