

7025 1" MALE SPRINKLER

Specification:

Connection Size: 1" male

Working Pressure: 2.76-4.83bar

Wet Diameter: 38.4-47.2m

Flow Rate: 3248-6291L/H



Features and Applications:

- Full-circle impacts distribute water at higher flows over a large diameter
- Outlast and costs less than brass sprinkler
- Built-in hex wrench for easy maintenance
- Made by heavy duty ABS/POM material, stainless steel springs and axis

Nozzle Diameter (mm)	Working Pressure (bar)	Flow Rate (L/H)	Wet Diameter (m)
6.35*3.57mm	2.76	3248	38.4
	3.45	3634	39.9
	4.14	3975	41.5
	4.83	4293	42.1
7.94*3.57mm	2.76	3861	40.2
	3.45	4315	41.8
	4.14	4724	43.9
	4.83	5110	44.8
9.53*3.57mm	2.76	4747	41.8
	3.45	5315	43.6
	4.14	5837	46.0
	4.83	6291	47.2



BOM list

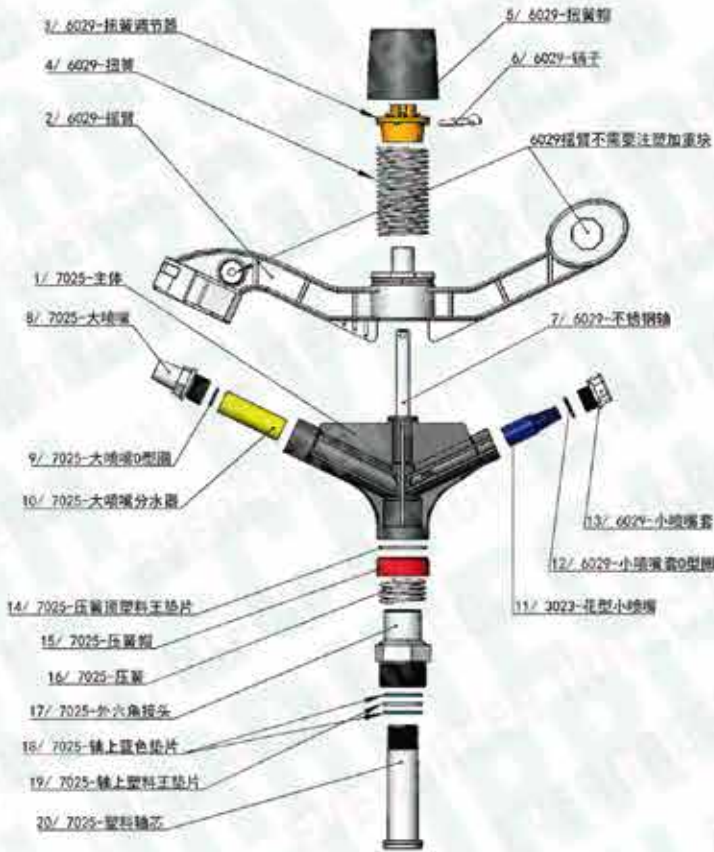

#	Material	Qty.	Size
1	POM	1	
2	POM	1	
3	POM	1	
4	SS	1	
5	POM	1	
6	POM	1	
7	SS	1	
8	POM	1	7.94
9	RUBBER	1	
10	POM	1	
11	POM	1	3.57
12	RUBBER	1	
13	POM	1	
14	TEFLON	1	
15	POM	1	
16	SS	1	1"
17	POM	1	
18	RUBBER	2	
19	TEFLON	1	
20	POM	1	

Related models



7025 SD

